

# ► LNP1210/9L

## Industrial Plastic Pallet

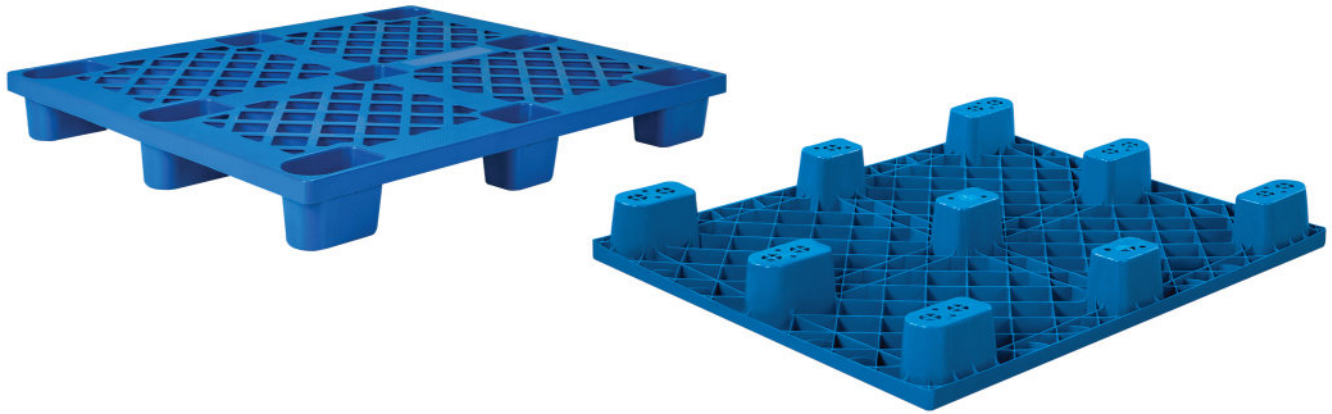

### Specifications:

Material	Virgin HDPE Inj. grade + UV Stabilizer
Dimension	1200 x 1000 x 140 mm (±5 mm)
Static Load	1400 Kg
Dynamic Load	700 Kg
Racking Load	x
Pallet Weight	6.5 Kg (±3%)
40' HC Cntr/88 m <sup>3</sup> TRK Capacity	1100 / 1300 Pcs

### More details:

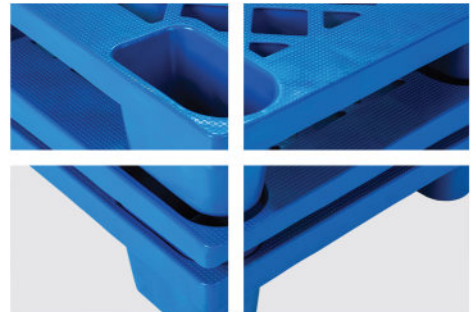

The load capacities are based on evenly distributed loads.

### Properties:

- Single surface
- Ventilated decks
- 9 Legs
- 4-way entry
- Forklift / Hand-jack compatible
- Nestable
- One shot

### Customization:

- Any standard RAL color
- 3 skid runners (Snap-On)
- Embossing logo
- Printing logo

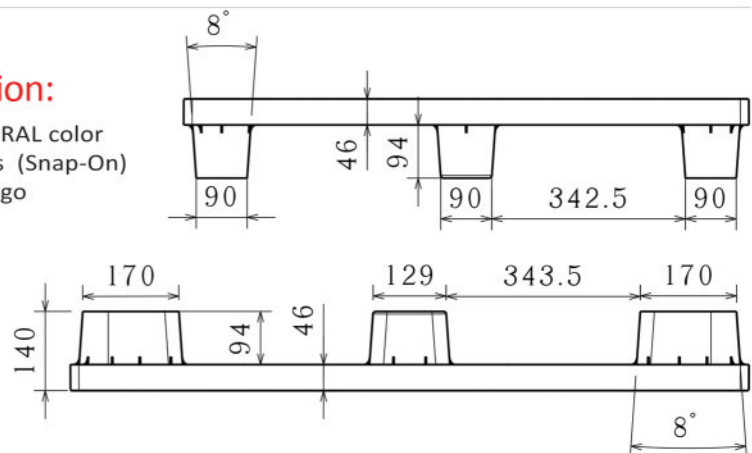

All dimensions may vary ±5 mm due to the production process & raw material characteristics.

